

1

2

3

4

5

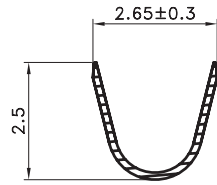

SEC.A-A

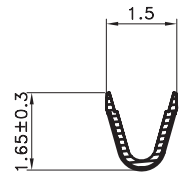

SEC.B-B

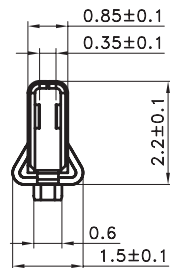

SEC.C-C

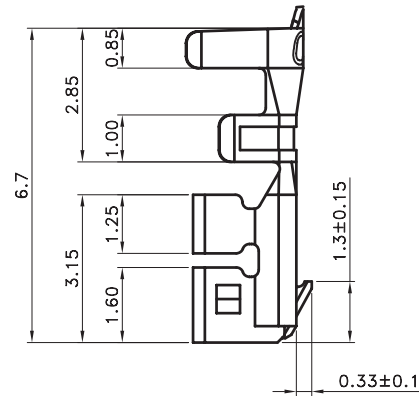
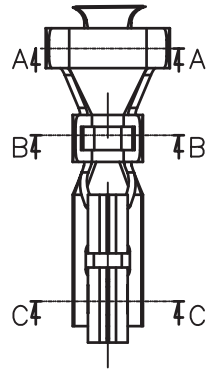

TECHNICAL CHARACTERISTICS

MATERIAL

CONTACT MATERIAL: COPPER ALLOY
CONTACT TYPE: STAMPED
CONTACT PLATING: TIN
QUALITY CLASS: 25 MATING CYCLES
PITCH: 2.00MM

ENVIRONMENTAL

OPERATING TEMPERATURE: -25 UP TO 85°C
COMPLIANCE: LEAD FREE AND ROHS

ELECTRICAL

CURRENT RATING: 3A
WORKING VOLTAGE: 250V AC
CONTACT RESISTANCE: 20 mOHM MAX

WIRE DIMENSION

AWG: AWG 22 - 28

PACKAGING

BULK/LOOSE DELIVERY IN A BAG
EACH TERMINAL SEPARATED FROM EACH OTHER
NOT ON A REEL
100PCS/PER BAG. MULTIPLE OF 100PCS ONLY
1PC OF 62400113722DEC =1 CRIMP TERMINAL
SO 1 BAG MEANS 100 PCS OF 62400113722DEC

RoHS Compliant

G				PROJECTION: 	GENERAL TOLERANCE .X = +/- 0.3 .XX = +/- 0.2		
F							
E							
D							
C	06-AUG-13	CHARACTERISTIC	QL	APPROVAL: RJ	UNIT: MM	DESCRIPTION: 2.00 MM DUAL ROW FEMALE CRIMP TERMINAL	SIZE A4
B	29-JUL-13	DWG & CARAC	QL		SCALE:		
A	15-MAY-12	PDF	GG		SHEET: 1/2	WERI PART NO: 62400113722DEC	
REV	DATE	FILE	BY		DRAW: MIKE		

1

2

3

4

5

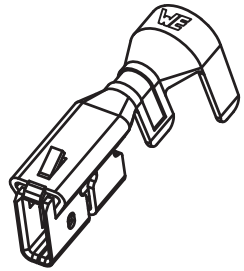

(A)

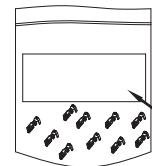

100PCS/BAG

Label

COVER

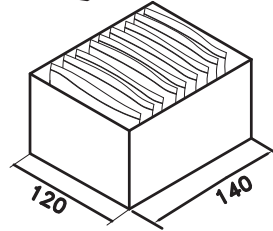
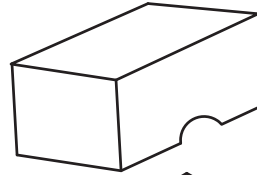

2KPCS/BOX

(B)

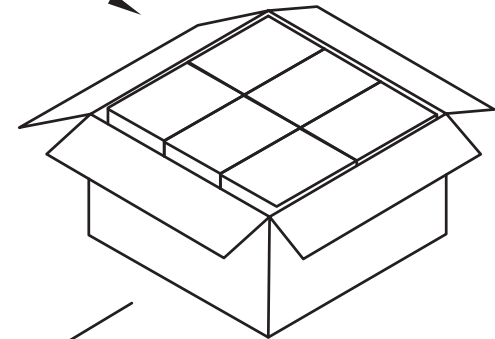

12BOX/Carlton



face 1
face 3

face 2
face 4

face 2

face 3

(C)

face 1

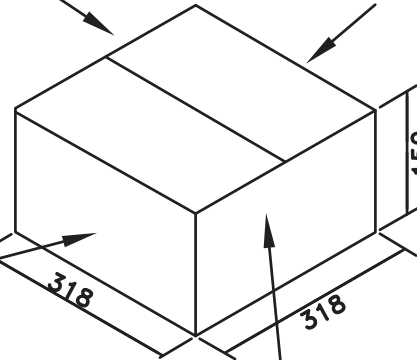

face 4

Note:
 1. Bag size: 100*120*0.06
 2. Box size: 120*140*60
 3. Carton size: 318*318*150

RoHS Compliant			
G			
F			
E			
D			
C			
B			
A			
REV	DATE	FILE	BY

PROJECTION:

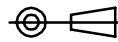

APPROVAL: RJ

GENERAL TOLERANCE

.X = +/- 0.2

.XX = +/- 0.15

UNIT: MM

SCALE:

SHEET: 2/2

DRAW: MIKE



DESCRIPTION: 2.00MM DUAL ROW FEMALE CRIMP CONTACT TERMINAL

WERI PART NO: 624 001 137 22 DEC

SIZE

A4

A

B

C

D